



Sahyadri Shikshan Mandal's

# **Mahant Jamanadas Maharaj Arts, Commerce and Science College**

Karanjali, Tal. Peth, Dist. Nashik – 422208, (MS) India

**(Affiliated to Savitribai Phule Pune University, Pune)**

Accredited by NAAC- 'C' Grade (CGPA-1.72)



## **Criterion-IV**

### **Infrastructure and Learning Resources**

#### **4.1.: Physical Facilities**

**4.1.1.: The Institution has adequate infrastructure and other facilities for, teaching – learning, viz., classrooms, laboratories, computing equipment etc**  
**•ICT – enabled facilities such as smart class, LMS etc. Facilities for Cultural and sports activities, yoga centre, games (indoor and outdoor), Gymnasium, auditorium etc.**



ID No. PU/NS/ACS/150/2009

॥ स्वदेशे पुज्यते राजा विद्वांसर्वत्र पुज्यते ॥

Govt. of Mah. Order No. N.G.C. 2009 (152/09) MS R - 4

Sahyadri Shikshan Mandal's Dindori

**Mahant Jamanadas Maharaj  
ARTS, COMMERCE & SCIENCE COLLEGE**

Karanjali, Tal. Peth, Dist. Nashik. (Maharashtra) 422 208. Ph.No.: 02558 - 234666

E-mail : mjmcollge1@yahoo.com College Code - 908

जावक क्र.: 186/2024-25

दिनांक : 20/12/2024

**DECLARATION**

This is to declare that the information, reports, true copies of the supporting documents, numerical data etc. submitted / Presented in the files is verified by Internal Quality Assurance Cell (IQAC) and it is correct as per the record.

This declaration is for the purpose of NAAC accreditation of HEI for the 2<sup>nd</sup> cycle period 2018-2019 to 2022-23.

Date:-20/12/2024

Place:-Karanjali

  
Dr. M.S. Shinde  
**I.Q.A.C. Co-ordinator**  
M.J.M. Arts, Commerce  
and Science College  
Karanjali, Nashik-422 208



  
Dr. U.P. Shinde  
**Principal**  
M.J.M. Arts, Commerce &  
Science College Karanjali,  
Tal. Peth, Dist. Nashik

### **4.1.1.: The Institution has adequate infrastructure and other facilities for, teaching – learning, viz., classrooms, laboratories, computing equipment etc**

### **ICT – enabled facilities such as smart class, LMS etc. Facilities for Cultural and sports activities, yoga centre, games (indoor and outdoor), Gymnasium, auditorium etc.**

Sahyadri Shikshan Mandal governing body believed that the use of modern technology and infrastructural facilities are important tools for the quality improvement of stakeholders. For providing the quality education the Mahant Jamnadas Maharaj Arts, Commerce and Science college spread over the area of 5 acres (20234.3 sq.mtr.) with the inspiration of vision and mission of slogan “Swadeshe Pujate Raja Vidwan Sarwasva Pujate” of institution.

The College has 9 classroom, 4 laboratory, 1 computer room and 1 library, 1 seminar hall, Examination department with Strong room. The classroom has various size for the different strength of students. All the classroom are adequate facilities for the students such as well-ventilated with fans and tubes lights. The sufficient number of benches are their related with the strength of students. All subject laboratories are well equipped with research facilities regarding practical of undergraduate students. The computer room have 15 computers for the students to use for studies otherwise in the college there are have 34 computers are working. Our college have well established library with sufficient number of book, periodicals and e-journals those are useful for the study of students and staff also.

#### **Examination Department**

After the teaching and learning process the evaluation of knowledge of the students is very important task of every instruction. Exam department has 1 exam room and 1 strong room with the IT facility 1 computer and 1 printer and Xerox machine with high speed Wi-Fi and LAN internet facility.

#### **N.S.S. Department**

Instruction have duty regarding to do the social work of your periphery region. National Service Scheme give this opportunity to college. Every year our college enrolled 50 students in NSS as per guidelines given by the Savitribai Phule Pune University. For the three years our NSS department adoptee one village and by following the instruction and rules of NSS department of Savitribai Phule Pune University to do various voluntary contribution of labour for the benefits of society. For example Soak pit, Block the water drain the water, rally regarding the population control, Child marriage awareness program etc.

NSS Department has NSS office with the IT facility 1 computer and 1 printer with Wi-Fi and LAN internet facility. Kitchen utensils for Special Camp were needed are purchase by NSS department.

#### **SWO Department**

Student welfare department promote earn and learn scheme for the students under the supervision of SWO department of Savitribai Phule Pune University. SWO department has SWO office with 1 computer and 1 printer with Wi-Fi and LAN internet facility.

## Adequate infrastructure and physical facilities



Adequate College Building

  
I.Q.A.C. Co-ordinator  
M.J.M. Arts, Commerce  
and Science College  
Karanjali, Nashik-422 206



  
Principal  
M.J.M. Arts, Commerce &  
Science College Karanjali,  
Tal. Peth, Dist. Nashik

Criterion IV: Infrastructure and Learning Resources

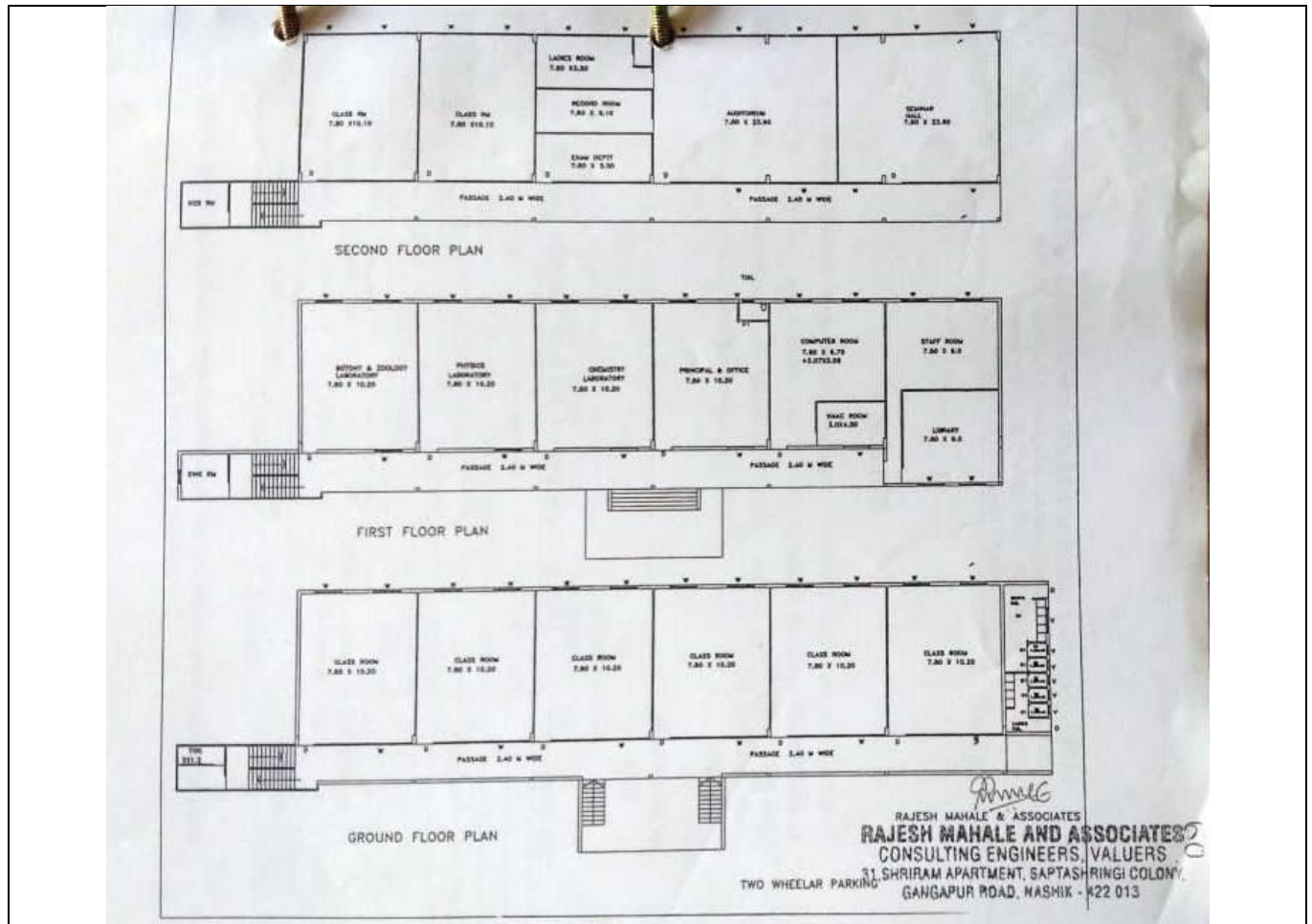

Plan of Building

*Quinal*  
I.Q.A.C. Co-ordinator  
M.J.M. Arts, Commerce  
and Science College  
Karanjali, Nashik-422 206



*Y. Shinde*  
Principal  
M.J.M. Arts, Commerce &  
Science College Karajali,  
Tal. Peth, Dist. Nashik

## Academic Facilities



Principal Cabin

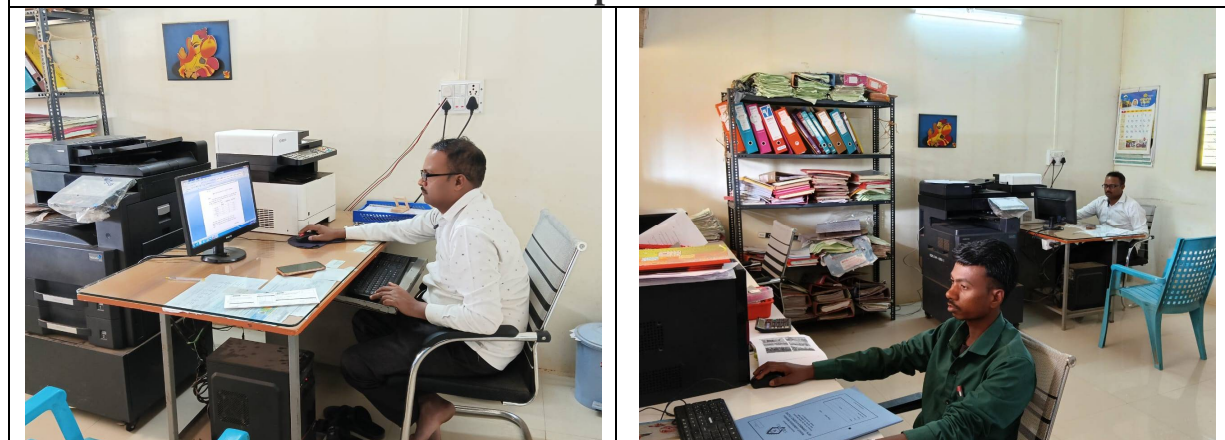

Office

**Criterion IV: Infrastructure and Learning Resources**



**IQAC Room**

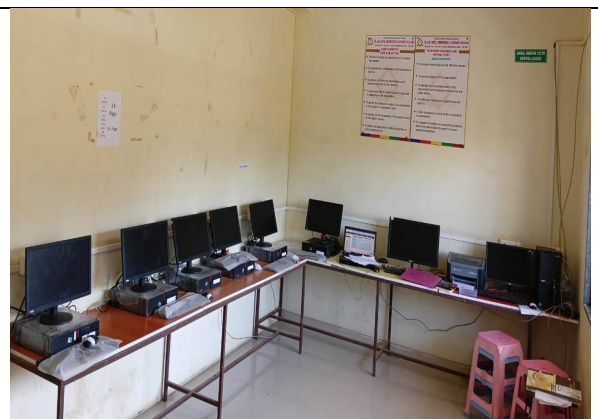

**Computer Room**



**Staff Room**



**Ramp for Handicap students**



**Exam Department**



**Strong Room**

**Criterion IV: Infrastructure and Learning Resources**



**Classroom**



**Ladies Room**



**Student Welfare Department**

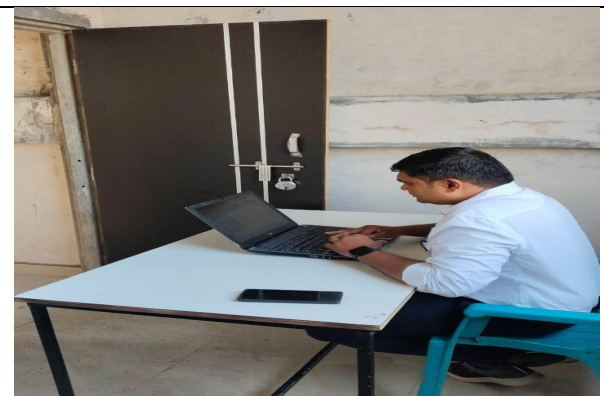

**National Service Scheme**

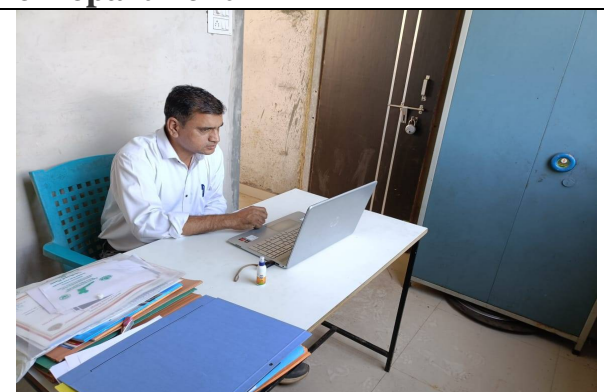



Criterion IV: Infrastructure and Learning Resources



**Seminar Hall**



**Zoology Lab**



**Chemistry Lab**



**Physics Lab**



**Botany Lab**

Criterion IV: Infrastructure and Learning Resources



Library

*Quinal*  
I.Q.A.C. Co-ordinator  
M.J.M. Arts, Commerce  
and Science College  
Karanjali, Nashik-422 206



*Y. Hindu*  
Principal  
M.J.M. Arts, Commerce &  
Science College Karajali,  
Tal. Peth, Dist. Nashik

The sports activity, games (indoor, outdoor), gymnasium, yoga centre etc.



**Kho-Kho**



**Indoor Wrestling**



**Yoga**



**Judo**



**Badminton**



**Cross Country**

Criterion IV: Infrastructure and Learning Resources



Football



Holly ball

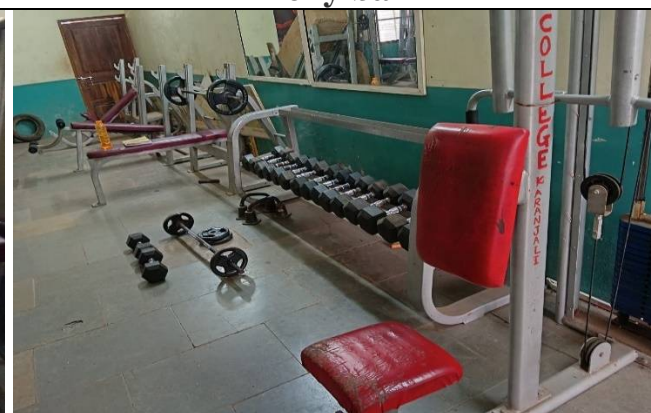

Gymkhana

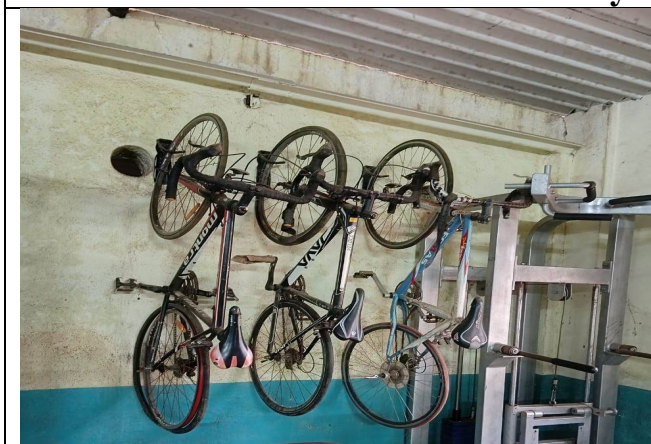

Cycling

*Dr. S. S. S. S.*  
I.Q.A.C. Co-ordinator  
M.J.M. Arts, Commerce  
and Science College  
Karanjali, Nashik-422 208



*Y. S. S. S.*  
Principal  
M.J.M. Arts, Commerce &  
Science College Karajali,  
Tal. Peth, Dist. Nashik

### Cultural Activity



Sari Day



Traditional Day



Black & White Day



Mismatch Day

*Quinal*  
I.Q.A.C. Co-ordinator  
M.J.M. Arts, Commerce  
and Science College  
Karanjali, Nashik-422 208



*Y. Hindu*  
Principal  
M.J.M. Arts, Commerce &  
Science College Karajali,  
Tal. Peth, Dist. Nashik

## College Gathering



**Inauguration ceremony**



**Students felicitation**



**Gathering**



**Adivasi Song performance**



**Criterion IV: Infrastructure and Learning Resources**



**MJM Fest 2023**



**MJM Gathering 2019-20**

*Shivani*  
**I.Q.A.C. Co-ordinator**  
**M.J.M. Arts, Commerce**  
**and Science College**  
**Karanjali, Nashik-422 206**



*Shivani*  
**Principal**  
**M.J.M. Arts, Commerce &**  
**Science College Karanjali,**  
**Tal. Peth, Dist. Nashik**

## ICT Facilities



Smart Board with internet connectivity



Xerox Machine



LCD Projector lecture

  
I.Q.A.C. Co-ordinator  
M.J.M. Arts, Commerce  
and Science College  
Karanjali, Nashik-422 206



  
Principal  
M.J.M. Arts, Commerce &  
Science College Karanjali,  
Tal. Peth, Dist. Nashik